

**NOTES:**

1. All construction shall be in conformity with City of San Bernardino, State of California, Specifications No. 2271, Standard Specifications for the Design and Construction of Improvements in Public Streets, Allys, 1895, and 1911 New Subdivisions.
2. The contractor shall acquire himself with the location of all utility lines and shall be responsible for the protection of same. The contractor shall be responsible for the removal and replacement of any utility lines damaged by such operations.
3. The existing lines in the neighborhood of the South Line of this tract and the construction of the same shall be removed and replaced with a Standard Type "A" Manhole. The balance of the construction shall be completed as shown hereon.
4. All sewer depths to be indicated from 8' sewer main to property line.

Bench Mark = Spike in Pole at the North West Corner of 27th & Harrison  
Elev = 1202.92

**CITY OF SAN BERNARDINO**  
 DIVISION OF ENGINEERING  
 TRACT NO. 4607  
 IMPROVEMENT PLAN AND PROFILES  
 2301

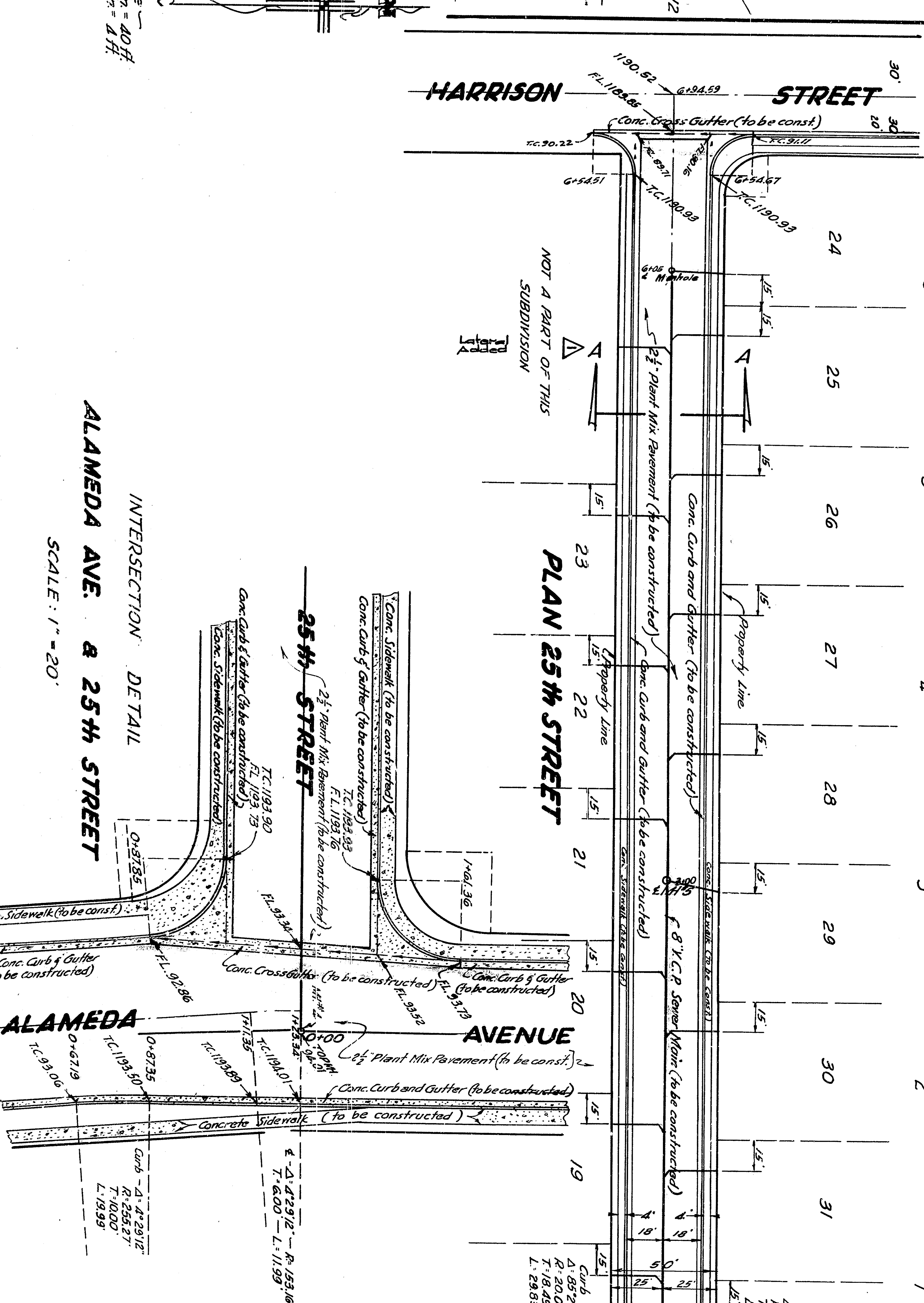
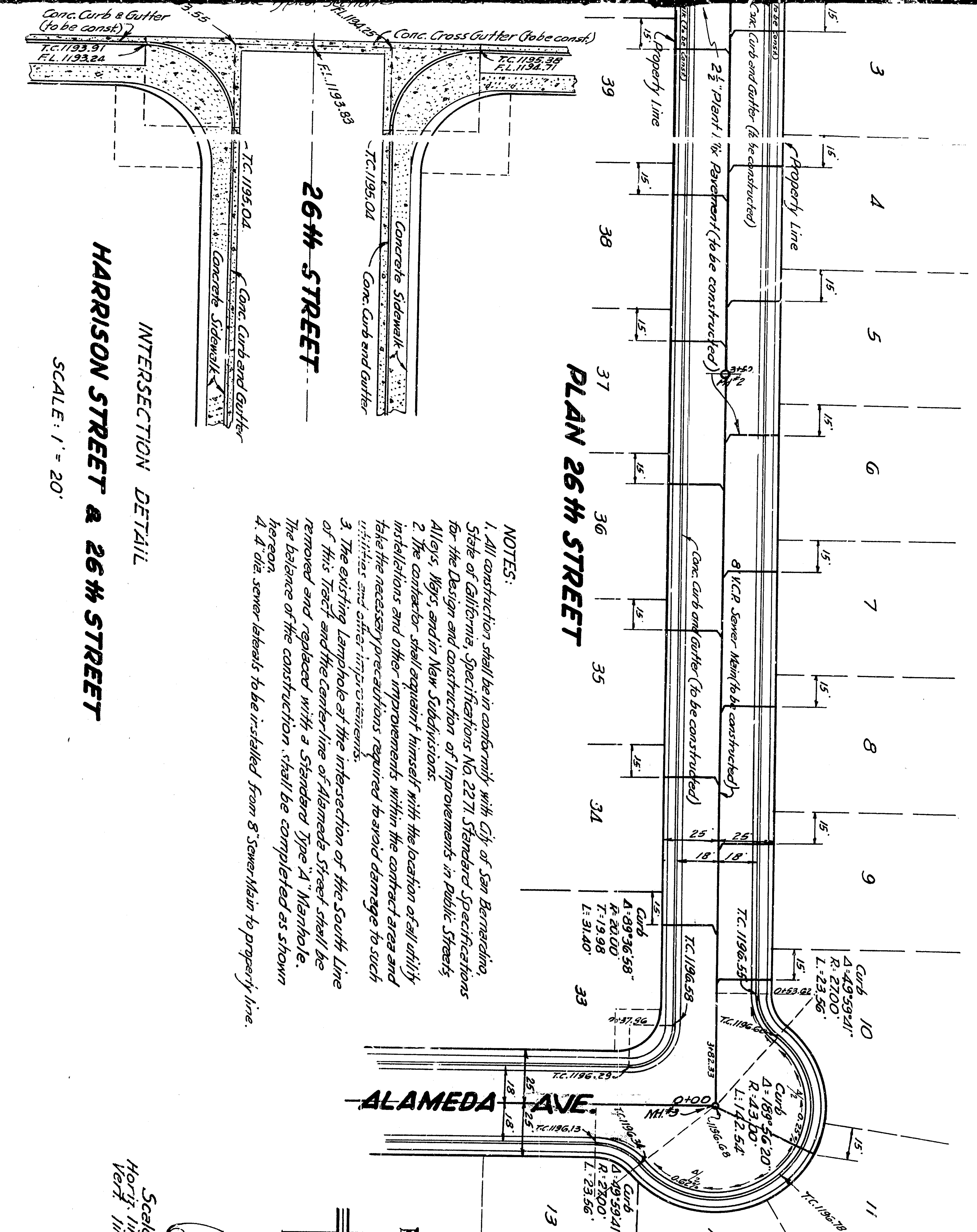

**TRACT NO. 4607**  
**IMPROVEMENT PLAN AND PROFILES**

APPROVED: *[Signature]* Jan. 28 1955  
 REGISTERED CIVIL ENGINEER NO. 2665

DESIGNED BY: *[Signature]*  
 CHECKED BY: *[Signature]*

CITY OF SAN BERNARDINO  
 ENGINEERING DIVISION  
 2301

Bench Mark = Spike in Pole at the North West Corner of 27th & Harrison  
 Elev. = 1202.92

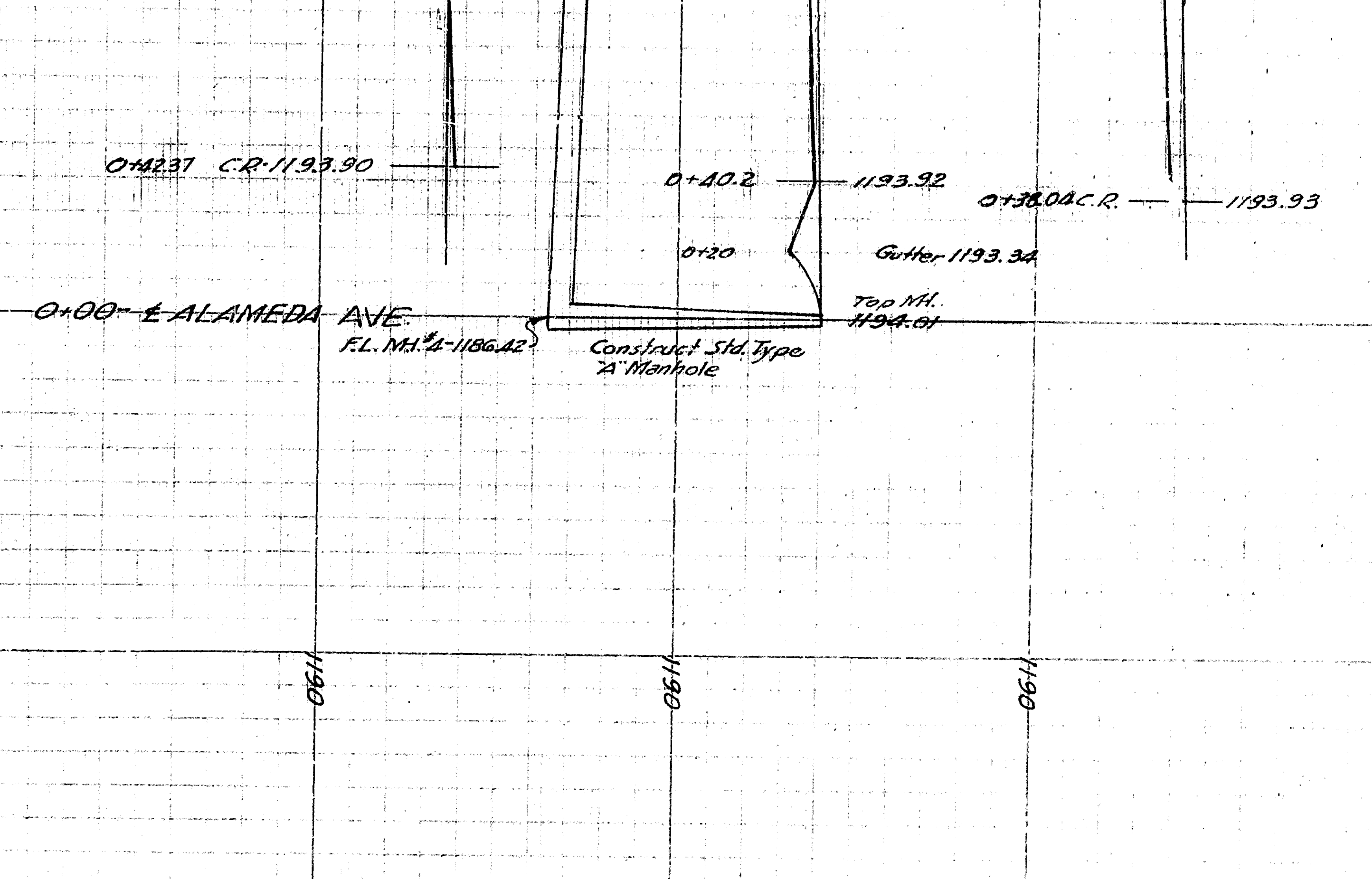
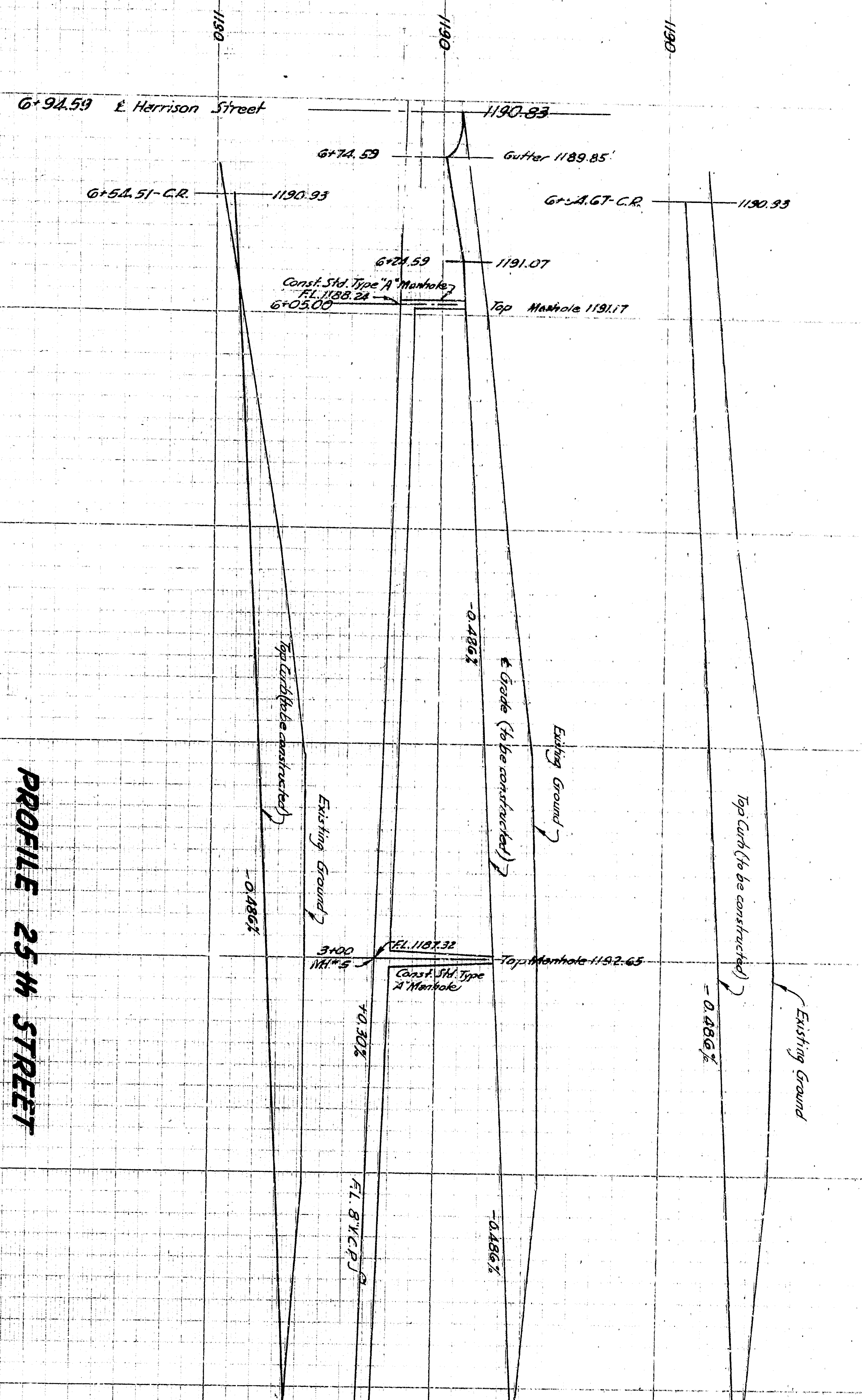
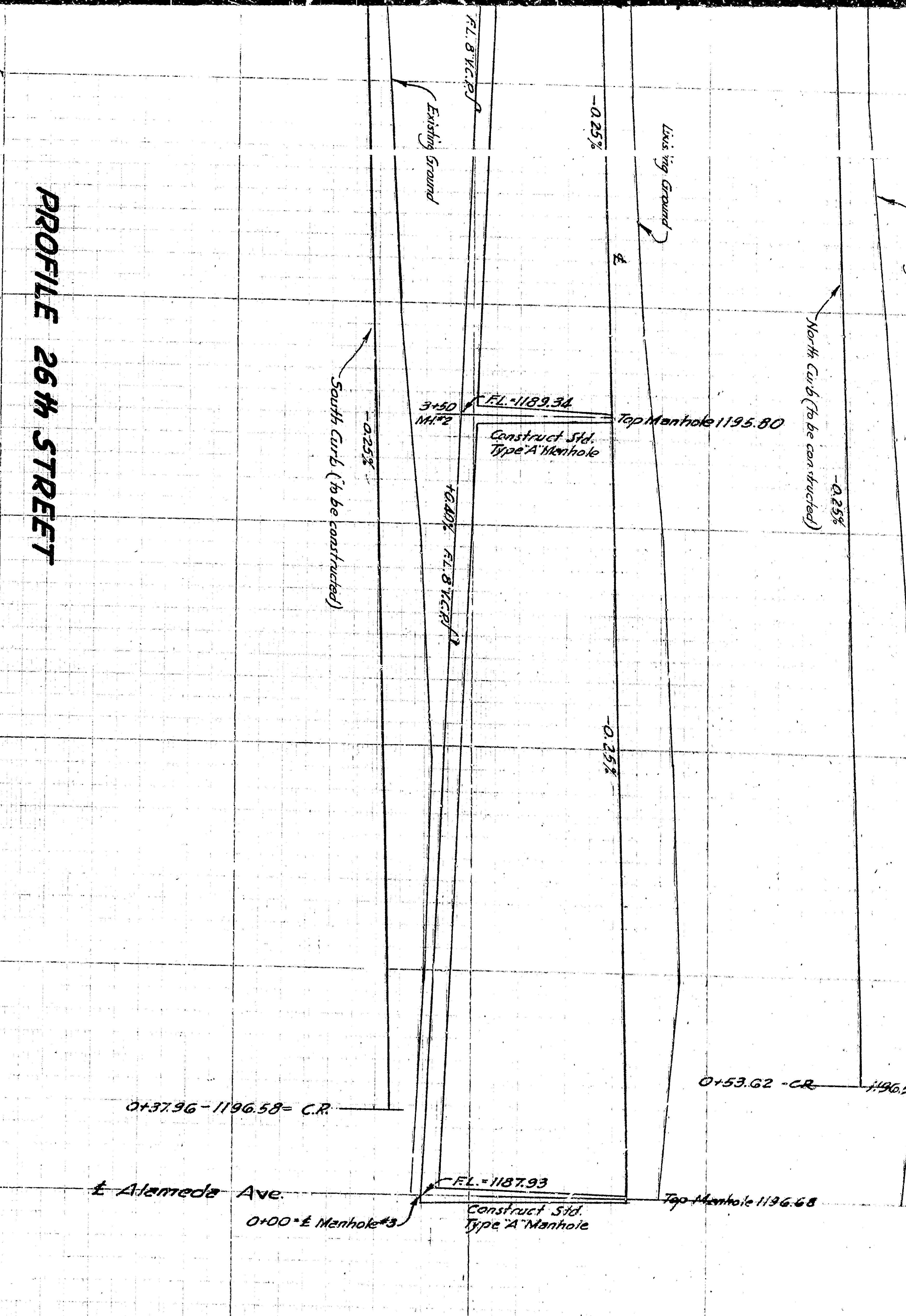

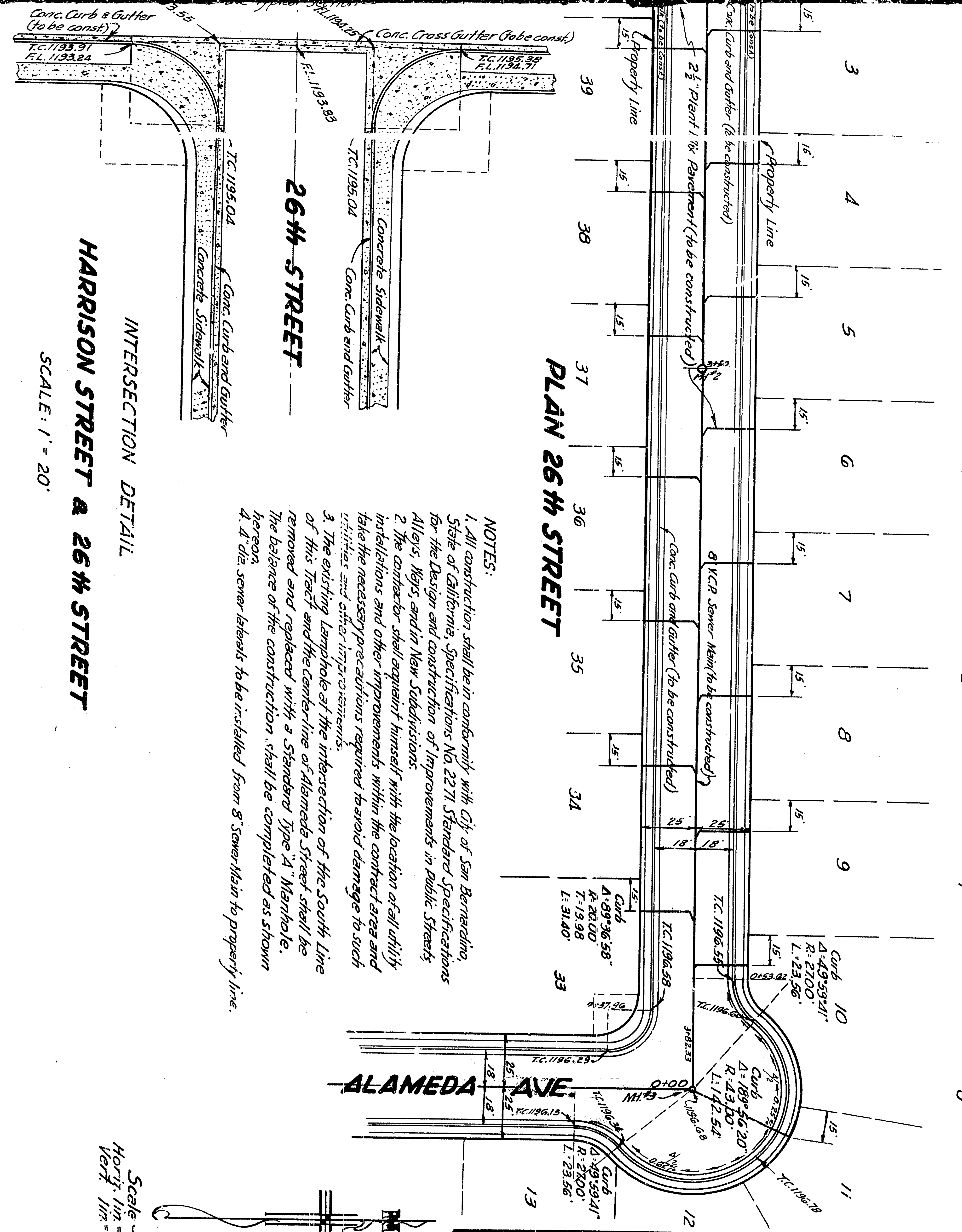

**HARRISON STREET & 26th STREET**  
INTERSECTION DETAIL  
SCALE: 1" = 20'

**NOTES:**

1. All construction shall be in conformity with City of San Bernardino, State of California, Specifications No. 2271, Standard Specifications for the Design and Construction of Improvements in Public Streets, Allys, 1895, and 1911 New Subdivisions.
2. The contractor shall acquire himself with the location of all utility lines and shall provide for their protection during the construction of this tract and shall be responsible for any damage to such utilities.
3. The existing lines are shown in dashed lines and the proposed lines are shown in solid lines.
4. All dimensions shall be in feet and inches.

Scale -  
Horizontal = 40' H  
Vertical = 1" H

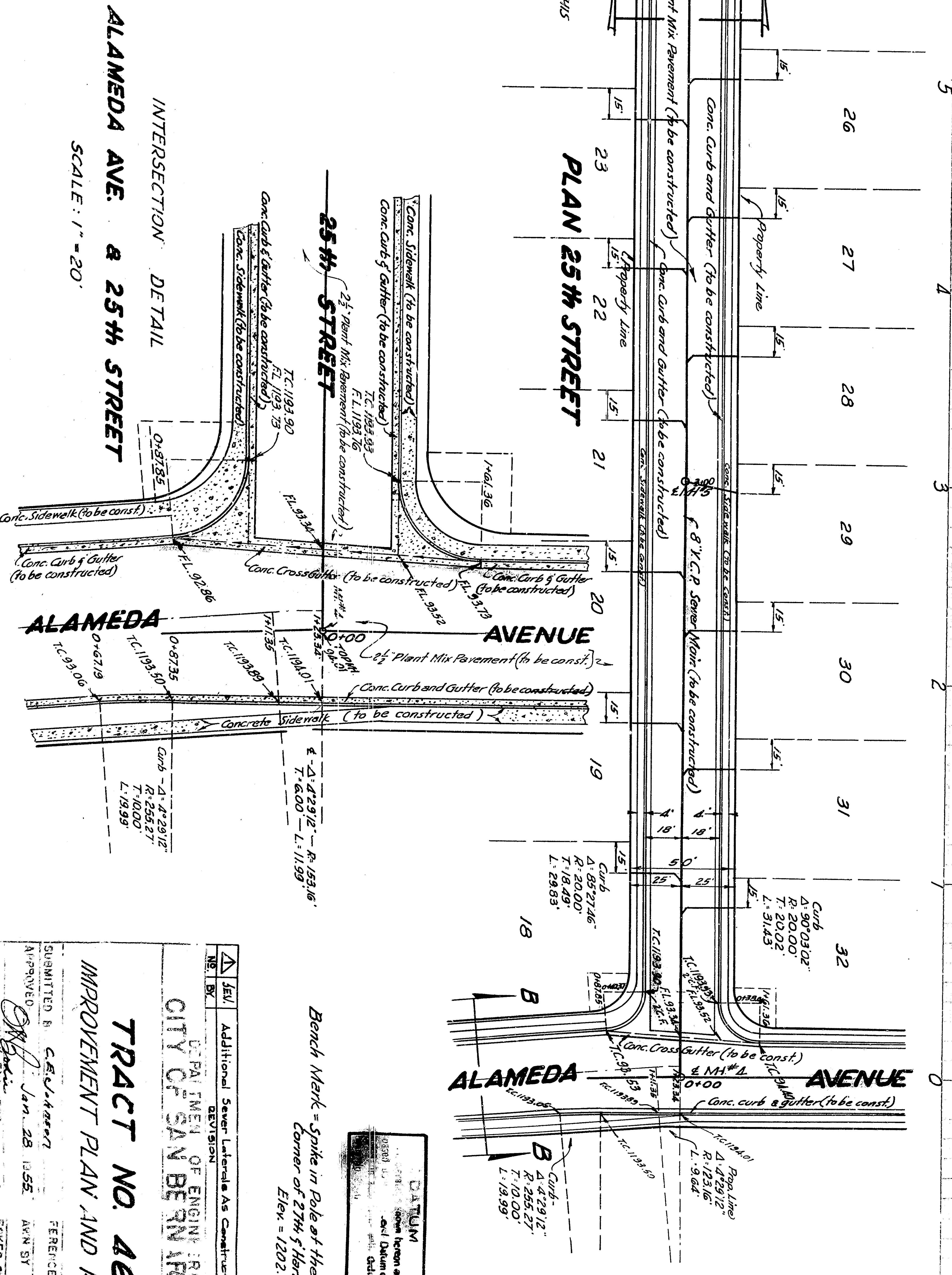

**ALAMEDA AVE. & 25th STREET**  
INTERSECTION DETAIL  
SCALE: 1" = 20'

**TRACT NO. 4607**  
**IMPROVEMENT PLAN AND PROFILES**

APPROVED: *[Signature]* Jan. 28 1955  
REGISTERED CIVIL ENGINEER NO. 2665

DESIGNED BY: *[Signature]*  
CHECKED BY: *[Signature]*

CITY OF SAN BERNARDINO  
DIVISION OF ENGINEERING

2301

Bench Mark = Spike in Pole at the North West Corner of 27th & Harrison  
Elev = 1202.92

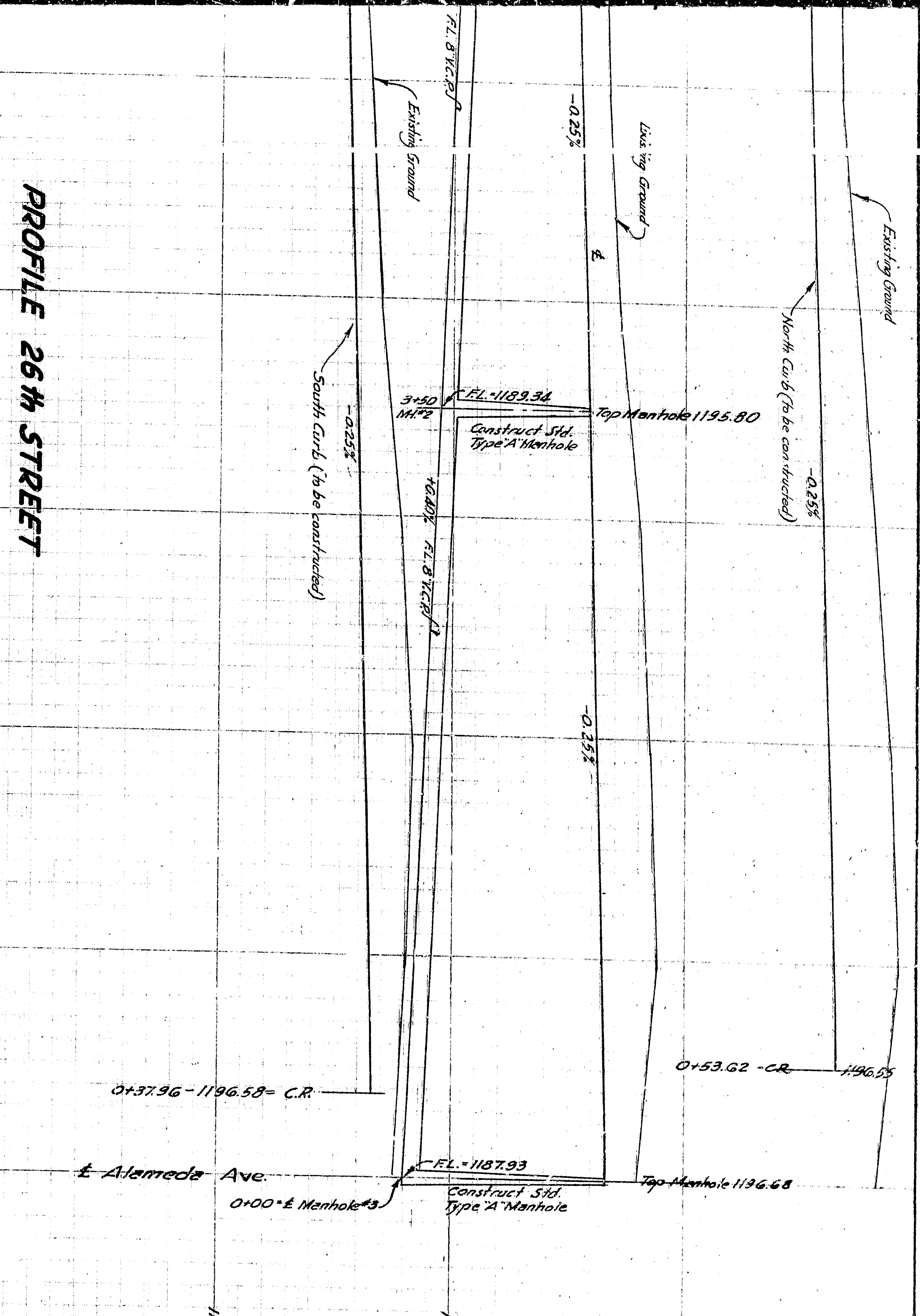

**PROFILE 26th STREET**

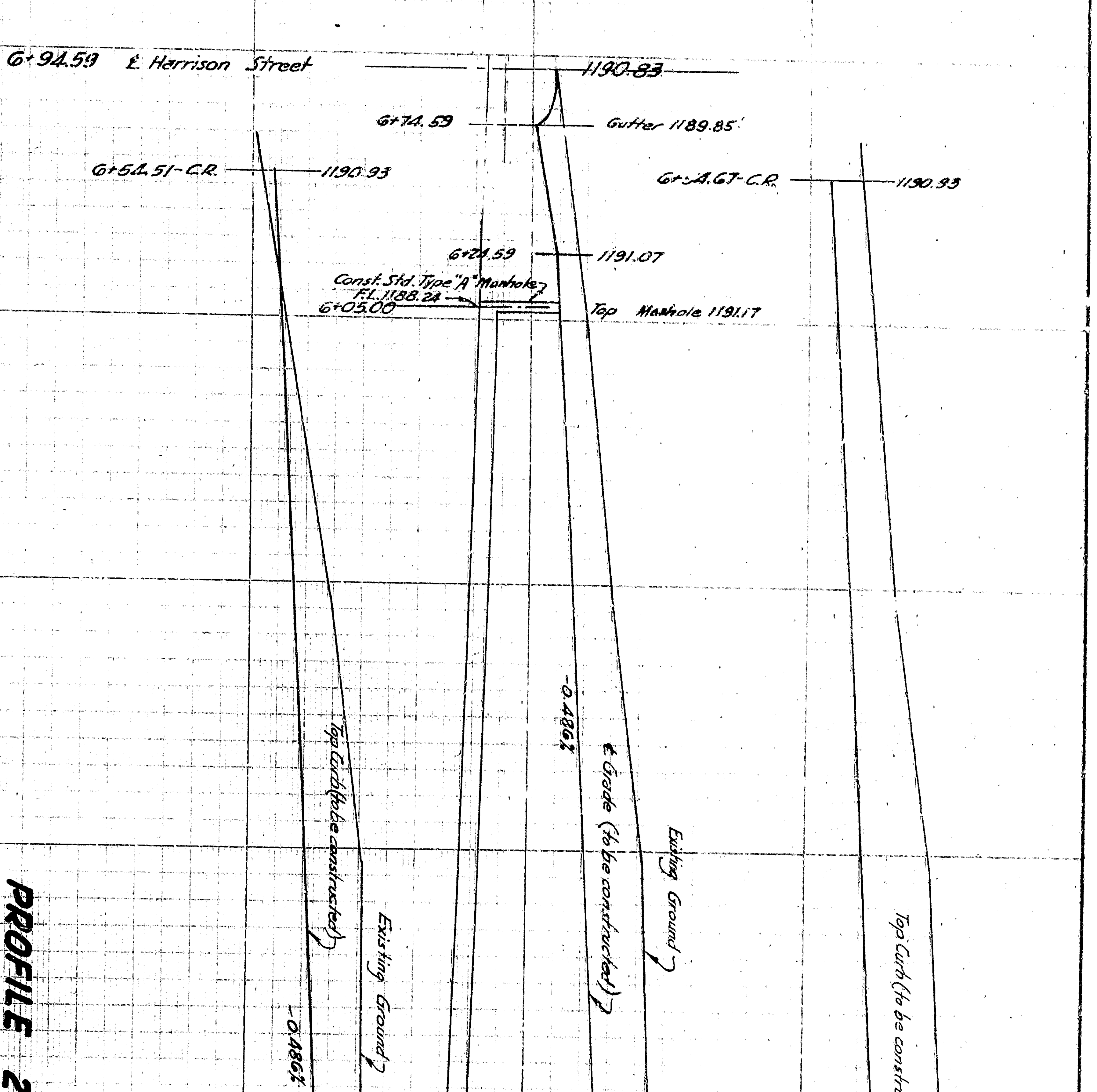

**PROFILE 25th STREET**

